



INSTALLATION INSTRUCTIONS

www.vikingbags.com

888-208-1949 | support@vikingbags.com

VIKINGBAGS UNIVERSAL WARRIOR MEDIUM SLANTED SADDLEBAGS VK04-HM INSTRUCTIONS

Parts

VK750 Hard Mount Bracket x 2
10mm x 55mm Socket Head Bolts x 4
Connecting Clamp x 2
Clamp Bolts (with a Nut and a Washer) x 2

Tools Required

3/8 drive metric socket set
A flat-blade or Philips screw driver
Adjustable wrench



Fig (A)

Instructions

Step 1

Starting from the right side first, hold your right Saddlebag against the fender to figure out the position where you would like to mount your Saddlebags. It would be much convenient to lend a helping hand for the following step.

Step 2

Once you have decided on a suitable position, mark the points on the back of the bag corresponding to the bolt positions on the fender.

Step 3

Drill the marked points on the back of the bag. While drilling, be careful not to drill through to the front panel (or pocket if there is one).

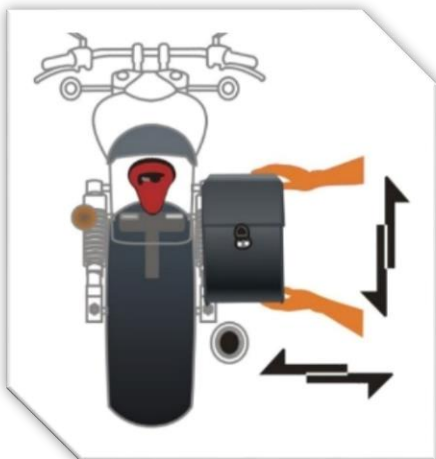

Fig (B)



Fig (C)



Fig (D)



INSTALLATION INSTRUCTIONS

www.vikingbags.com

888-208-1949 | support@vikingbags.com

Step 4

Placing the bag on the floor and using the supplied bolts to hold the bracket in position, place the connecting clamp onto the bracket as shown and mark the position of the clamp hole.

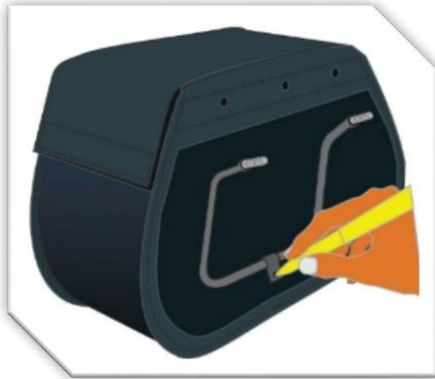

Fig (E)

Step 5

Drill at the marked point and use a Clamp Bolt along with a washer to tightly bolt on the Connecting Clamp to the Saddlebag.



Fig (F)

Step 6

Now hold the bag and bracket against the fender holes and insert from inside, the Socket Head Bolts through the 2 holes in the bag, into the Hard Mount Bracket holes and finally into the fender holes and tighten the bolts.

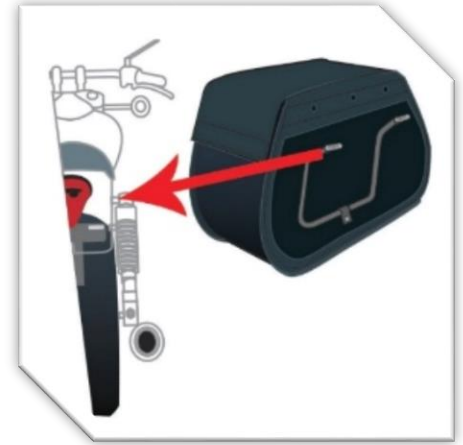

Fig (G)

Step 7

Repeat the same process for the left side.



Fig (G)

⚠ Warnings

- ✓ Avoid usage of any mounting part that is impaired or is not working properly.
- ✓ If you are not secure about the installation of the saddlebags, do not use them.
- ✓ Sporadically check for shifting of the bag and verify that no part of the mounting system is interfering with any part of the motorcycle while riding. This includes the drive train, suspension, brakes or wheels.
- ✓ It is important to note that if you do not mount these saddlebags properly damage may be caused to the saddlebags and/or motorcycle.
- ✓ If bags are securely installed, no part of the mounting system or bags should touch the motorcycle while in operation.
- ✓ Do not attempt to use these saddlebags if the mounting instructions are unclear. It is important that you seek professional assistance from a qualified mechanic or dealer.